

Verdere besonderhede van die dorpstigting lê ter insae gedurende gewone kantoorure by die Emfuleni Plaaslike Munisipaliteit, SSK, Vanderbijlpark, vir 'n periode van 28 (agt-en-twintig) dae vanaf 6 Augustus 2014.

Besware teen of verhoë ten opsigte van die dorpstigting moet skriftelik by of tot die Munisipale Bestuurder by bovermelde adres of by Posbus 3, Vanderbijlpark, 1900, of by Emendo Inc., Posbus 5438, Meyersdal, 1447, binne 'n tydperk van 28 dae vanaf 6 Augustus 2014, ingedien of gerig word.

*Sluitingsdatum:* 12 September 2014

*Adres van gemagtigde agent:* Motsamai Mofokeng, Emendo Inc., PO Box 5438, Meyersdal, 1447. Tel: (011) 867-1160. Faks: (011) 867-6435.

06-13

## NOTICE 2424 OF 2014

### CITY OF JOHANNESBURG

#### NOTICE OF APPLICATION FOR ESTABLISHMENT OF TOWNSHIP

The City of Johannesburg Metropolitan Municipality hereby gives notice in terms of section 96 of the Town-planning and Townships Ordinance, 1986 (Ordinance No. 15 of 1986), that an application to establish the township referred to in the Annexure hereto, has been received by it.

Particulars of the application will lie for inspection during normal office hours at the offices of the City of Johannesburg, Executive Director: Development Planning, 8th Floor, Metropolitan Centre, 158 Civic Boulevard, Braamfontein, Information Counter, for a period of 28 days from 6 August 2014.

Objections to or representations in respect of the application must be lodged with or made in writing to the City of Johannesburg, Executive Director: Development Planning, at the abovementioned address or at PO Box 30733, Braamfontein, 2017, within a period of 28 days from 6 August 2014.

#### ANNEXURE

*Name of township:* **Riverside View Extension 58.**

*Full name of applicant:* Guy Balderson Town Planners, on behalf of H E Felber (Pty) Ltd.

*Number of erven in proposed township:* 2

Erf 1 shall be zoned "Special", for offices, medical suites, places of instruction, dwelling units, hotels and ancillary uses, subject to certain conditions.

Erf 2 shall be "Residential 3" with a density of 160 dwelling units per hectare, subject to certain conditions.

*Description of land on which township is to be established:* Holding 16, Kleve Agricultural Holdings.

*Locality of proposed township:* Situated at the north east corner of Erling and Dorothy Roads, Kleve Agricultural Holdings. The street address is 16 Dorothy Road, Kleve Agricultural Holdings.

*Authorised agent:* Guy Balderson Town Planners, PO Box 76227, Wendywood, 2144. Tel. (011) 656-4394.

## KENNISGEWING 2424 VAN 2014

### STAD VAN JOHANNESBURG

#### KENNISGEWING VAN AANSOEK OM DORPSTIGTING

Die Stad van Johannesburg Metropolitaanse Munisipaliteit gee hiermee ingevolge artikel 96 van die Ordonnansie op Dorpsbeplanning en Dorpe, 1986 (Ordonnansie 15 van 1986), kennis dat 'n aansoek om die stigting van 'n dorp, soos verwys in die Bylae hieronder, ontvang is.

Besonderhede van die aansoek lê ter insae gedurende gewone kantoorure by die kantoor van die Uitvoerende Beampte: Ontwikkelingsbeplanning en Stedelike Beheer, 8ste Verdieping, Metropolitaanse Sentrum, Lovedaystraat 158, Braamfontein, vir 'n tydperk van 28 dae vanaf 6 Augustus 2014.

Besware teen of verhoë ten opsigte van die aansoek moet binne 'n tydperk van 28 dae vanaf 6 Augustus 2014 skriftelik by of tot die Uitvoerende Beampte : Ontwikkelingsbeplanning en Stedelike Beheer, by die bovermelde adres of by Posbus 30733, Braamfontein, 2017, ingedien of gerig word.

#### BYLAE

*Naam van dorp:* **Riverside View Uitbreiding 58.**

*Volle naam van aansoeker:* Guy Balderson Town Planners, vir H E Felber (Pty) Ltd.

*Aantal erwe in voorgestelde dorp:* 2

Erf 1 gesoneer word "Spesiaal", vir kantore, mediese kamers, plekke van onderrig, wooneenhede, hotelle en aanverwante gebruike, onderworpe aan sekere voorwaardes.

Erf 2 gesoneer word "Residensieel 3" met 'n digtheid van 160 wooneenhede per hektaar, onderworpe aan sekere voorwaardes.

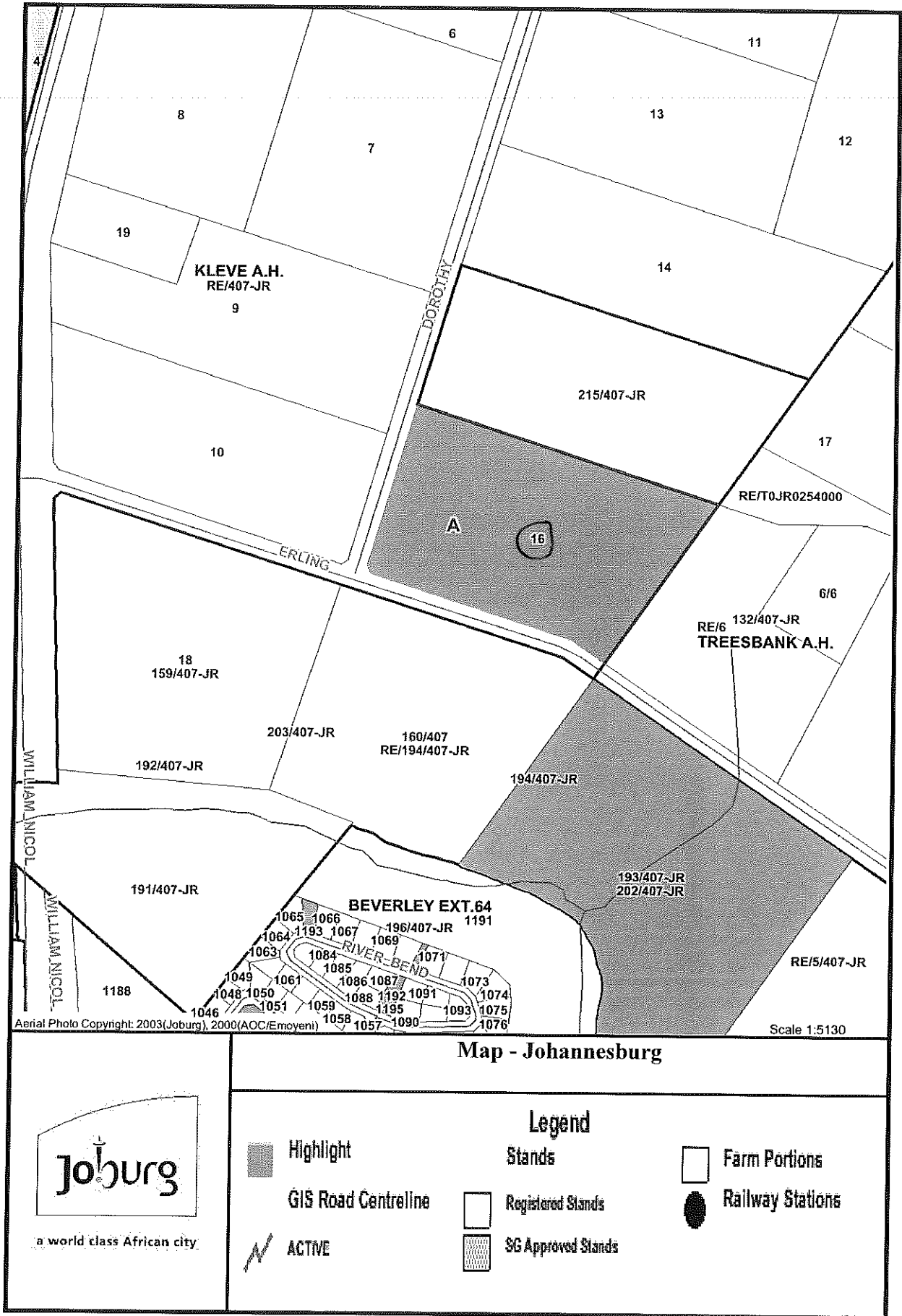

Afskrifte van die aansoek soos goedgekeur word in bewaring gehou deur die Uitvoerende Direkteur: Ontwikkelings Beplanning en Stedelike Beheer, Boulevardstraat 158, Braamfontein, 8ste Vloer, A-Blok, Burgersentrum, en is beskikbaar vir inspeksie op alle redelike tye.

Hierdie wysiging staan bekend as wysigingskema as 05-12050 en tree in werking op 13 Augustus 2014 die datum van publikasie hiervan.

**Adjunk Direkteur: Legal Administration**

*Datum:* Augustus 2014

(Kennisgewing No. 437/2014)

---

---

## LOCAL AUTHORITY NOTICE 1056

### CITY OF JOHANNESBURG

#### AMENDMENT SCHEME 07-11473

It is hereby notified in terms of section 57 (1) of the Town Planning and Townships Ordinance, 1986, that the City of Johannesburg approved the amendment of the Halfway House and Clayville Town Planning Scheme, 1976, by the rezoning of **Portion 516 (a portion of Portion 63) of the Farm Witpoort 406-JR** from "Agricultural" to "Special" for a hotel and ancillary and related uses, subject to the following conditions.

Copies of application as approved are filed with the offices of the Executive Director: Development Planning and Urban Management, 158 Civic Boulevard Street, Braamfontein, 8th floor, A-block Civic Centre, and are open for inspection at all reasonable times.

This amendment is known as amendment scheme 07-11473 and shall come into operation on 6 August 2014 the date of publication hereof.

**Deputy Director: Legal Administration**

*Date:* 6 August 2014

(Notice No. 428/2014)

---

---

## PLAASLIKE BESTUURSKENNISGEWING 1056

### STAD VAN JOHANNESBURG

#### WYSIGINGSKEMA 07-11473

Hierby word ooreenkomstig die bepalings van artikel 57 (1) van die Ordonnansie op Dorpsbeplanning en dorpe, 1986, bekendgemaak dat die Stad van Johannesburg goedgekeur het dat die Halfway House en Clayville dorpsaanlegskema, 1976 gewysig word deur die hersonering van **Gedeelte 516 ('n gedeelte van gedeelte 63) van die Pleas Witpoort 406-JR** vanaf "Landbou" na "Spesiaal" vir 'n hotel en aanverwante gebruike, onderworpe aan sekere gewysigde voorwaardes.

Afskrifte van die aansoek soos goedgekeur word in bewaring gehou deur die Uitvoerende Direkteur: Ontwikkelings Beplanning en Stedelike Beheer, Civicboulevardstraat 158, Braamfontein, 8ste vloer, A-Blok, Burgersentrum, en is beskikbaar vir inspeksie op alle redelike tye.

Hierdie wysiging staan bekend as wysigingskema as 07-11473 en tree in werking op 6 Augustus 2014 die datum van publikasie hiervan.

**Adjunk Direkteur: Regsadministrasie**

*Datum:* 06 Augustus 2014

(Kennisgewing No: 428/2014)

---

---

## LOCAL AUTHORITY NOTICE 1057

### CITY OF JOHANNESBURG

#### AMENDMENT SCHEME 16-14061

It is hereby notified in terms of section 57 (1) of Annexure F of the Township Establishment and Land Use Regulations (1986) of the repeal Black Communities Development Act No. 4 of 1984, that the City of Johannesburg approved the amendment of the Annexure F, by rezoning of Erf 1779, Mofolo North, from "Public Road", to "Business".

Copies of application as approved are filed with the Executive Director: Development Planning and Urban Management, 158 Loveday Street, Braamfontein, 8th floor, A block Civic Centre, open for inspection at all reasonable times.

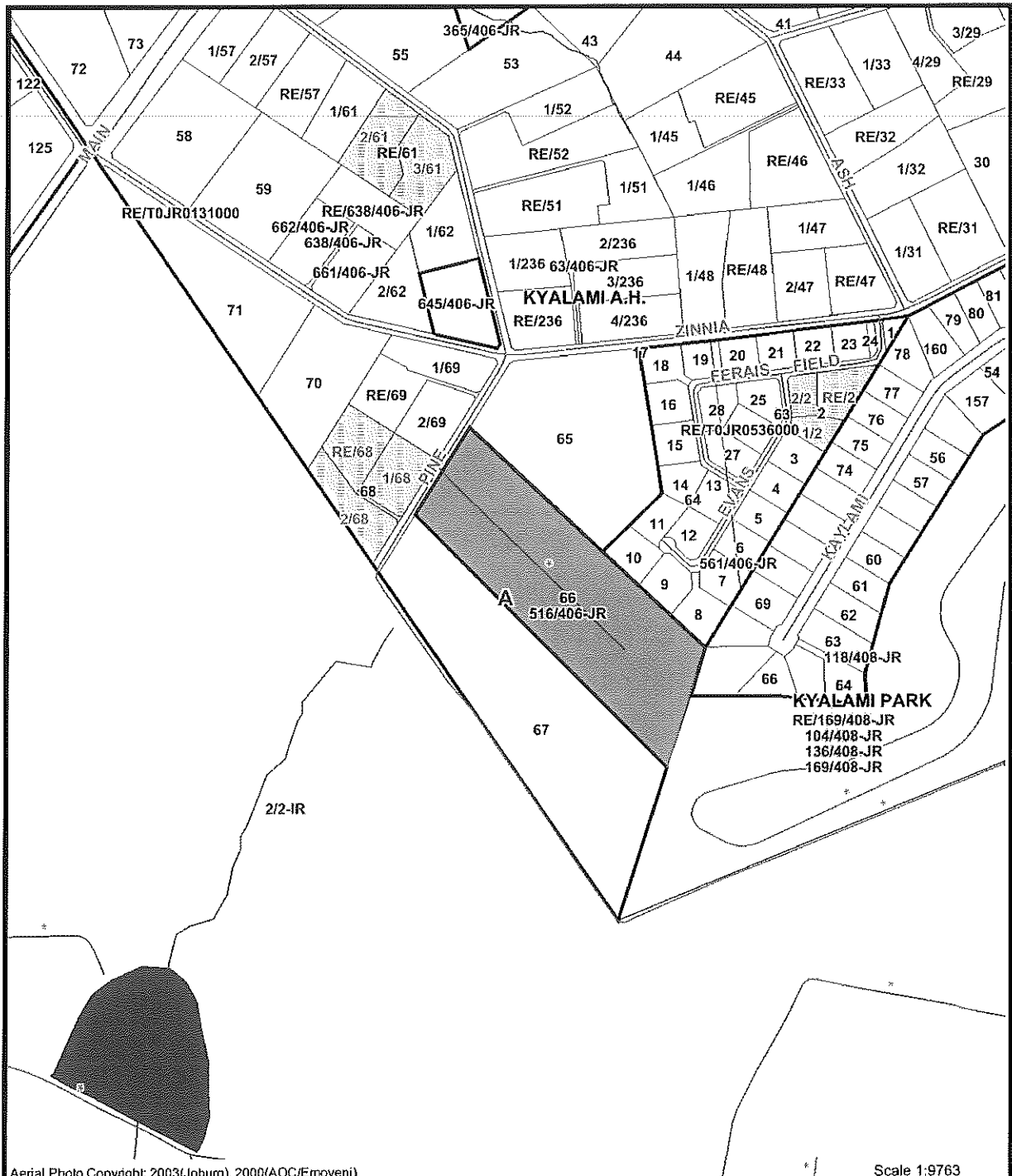

Aerial Photo Copyright: 2003(Joburg), 2000(AOC/Emoyeni)









Scale 1:9763

### Map - Johannesburg



a world class African city

### Legend

- |   |  |  |
|---|--|--|
|  Highlight           |  Stands             |  Farm Portions    |
|  GIS Road Centreline |  Registered Stands  |  Railway Stations |
|  ACTIVE              |  SG Approved Stands |  |